

YOU CAN KEEP YOUR FAMILY SAFE FROM EARTHQUAKES BUILD WITH TIMBER INSTEAD OF MASONRY



Destroyed Masonry Home



Intact Timber Home

Timber House
Safer
Cheaper
Faster

Timber is more flexible and lighter weight than bricks. It is easier and less expensive to build a safe, comfortable house from timber. A timber house is a better choice if you are building on soft soil or a sloped site as the timber house has fewer problems due to settling. It is also easier to repair if damaged.

FOLLOW THESE SIMPLE RULES TO BUILD AN EARTHQUAKE RESISTANT SEMI PERMANENT HOUSE:

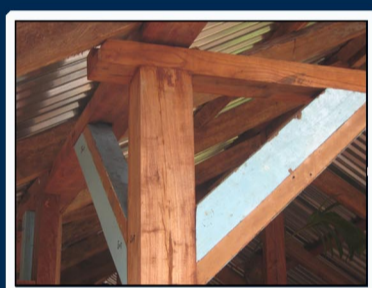

Diagonal bracing in all 4 corners

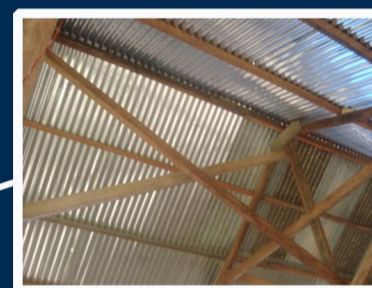

Wind bracing between truss



Every connection must have peg



Use proper splice joinery



Keep wood column off ground with concrete starter

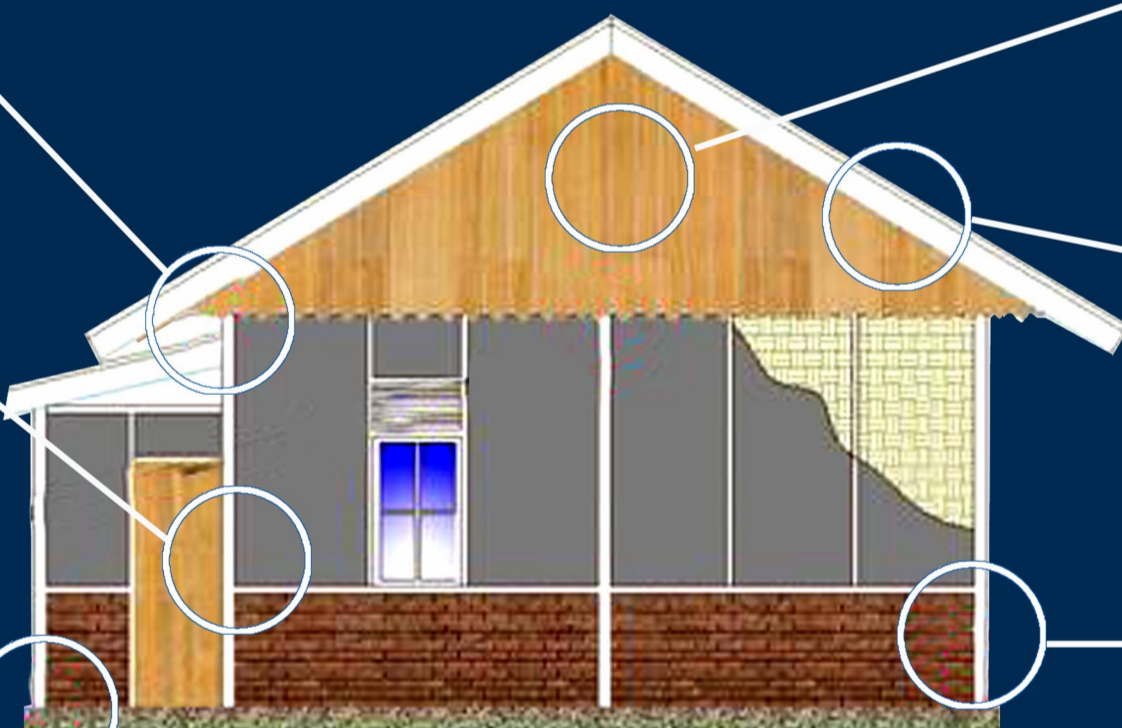

The masonry skirt may be made from bricks or concrete blocks but it must have a nail connecting masonry to column



Before plastering, be sure to paint all timber with preservative paint



Install the chain-link lath and bend nails over to stretch it tightly



Install backing boards and plaster



World Vision



For more information, please contact
Build Change at build.indonesia@gmail.com
or through CRS office: Hotel Permata Bunda,
Jl.Gajah Mada No. 316, Agam-Lubuk Basung.
For 24-hour help-line please contact CRS at:
0751-9071370